

NORTH POINT

CABINETS®



Thoughtfully Designed, Carefully Crafted



The NorthPoint Cabinetry Solution

Made in North America, NorthPoint Cabinetry features a wide array of **QuickBuild**® cabinet designs, providing value with a quality, custom look. Cabinets are in stock, shipping quickly from our strategically located warehouses across the U.S.

- Unique dovetail and pocket screw cabinet construction for sturdy and fast assembly
- Robust replacement parts program
- Free freight on most orders
- Dedicated customer service support



With 5 dedicated warehouses across the country, NorthPoint Cabinetry typically ships within 48 hours and arrives in 2–3 business days.



For more information,
visit [NorthPointCabinetry.com](https://www.NorthPointCabinetry.com)
or scan the QR code.

The Quick Advantage

Ships QUICKLY, Assembles FAST

NorthPoint Cabinetry offers a **quick** advantage for you and your customer by making it fast and easy to design, order, ship & assemble cabinets. *Why does this matter?* With a reduction in time and labor, you can complete more jobs and see significant savings.

Some specific ways the NorthPoint Cabinetry Quick Advantage can save you time & money:

- **Quick to Design**

Our cabinets are available in 2020 and ProKitchen software, making kitchen design fast and easy.

2020



- **Quick to Order**

Place an order for your cabinets with our quoting tool, on our website at NorthPointCabinetry.com, or by contacting a live customer service agent.

- **Quick to Ship**

With 5 dedicated warehouses across the country, orders typically ship within 48 hours and arrive in 2–3 business days.

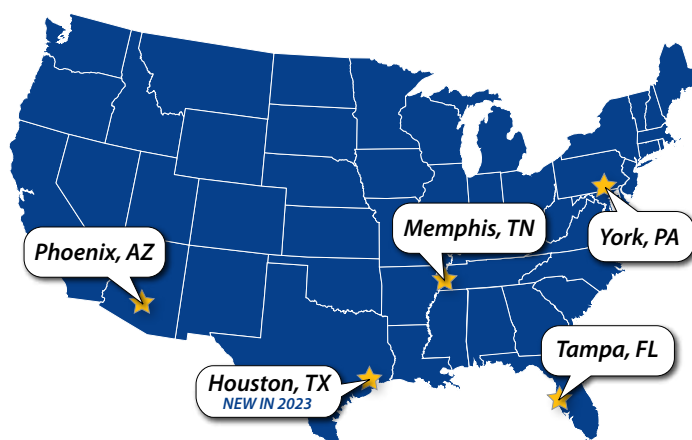

- **Quick to Assemble**

With our **QuickBuild®** cabinets, the average assembly time per cabinet is 8 minutes*; you can build a medium sized kitchen in less than half a day.

*Specialty cabinets may take longer than average to assemble.

Quality Comes First

You can trust NorthPoint Cabinetry for your customers. Our cabinets and hardware have gone through rigorous third-party testing and meet KCMA standards. With quality details throughout and features your customer will appreciate, NorthPoint Cabinetry is built to last.



It Starts with Quality Wood

Just as a healthy tree needs strong roots to thrive, a quality cabinet requires premium lumber at its core. The quality of wood is of utmost importance, so our cabinets feature solid wood construction.

Structural Integrity

Meaningful yet hidden reinforcements — like solid wood corner blocks and strategically placed pocket screws — help reinforce the structural integrity of the cabinet. Take comfort that these well-constructed cabinets will stand the test of time.



Thoughtful Craftsmanship

These cleverly designed cabinets boast an innovative dovetail and hidden pocket screw construction that provides robust quality and quick, accurate assembly.



Pretty on the Inside, Too

NorthPoint Cabinetry features a clean and beautifully finished birch interior that enhances the cabinet's luxurious, high-quality appeal.

Premium Drawer Boxes

Dovetail joinery is the hallmark of high-quality drawer boxes. The UV finish of the drawer boxes coupled with the dovetail construction, and smooth concealed slides are synonymous with quality furniture.



Hardworking Hardware

Our cabinets feature discreet compact hinges and concealed undermount slides. The hinges and slides have been third-party tested and exceed industry standards. The Premier collection (shown) features full extension slides allowing for easy access and use of the whole drawer.

Sturdy Shelves

NorthPoint Cabinetry shelves are constructed from an impressive $\frac{3}{4}$ " thick veneered plywood, preventing sagging over time under the weight of normal use. Shelf height is adjustable, so the homeowner can optimize storage space.



Expert Finishing

Count on consistent, high-quality finishing. Our state-of-the-art manufacturing facility utilizes a multi-step professional finishing process. This meticulous process maintains a high degree of color and application accuracy from cabinet to cabinet, ensuring a beautiful run of cabinets when installed.

Our cabinets and accessories feature water-based ultraviolet (UV) finishes. Water-based UV finishes emit low Volatile Organic Compounds (VOCs) and are environmentally responsible. UV finishing uses light instead of heat for curing, and the benefits include no environmental pollutants or solvents to evaporate, increased chemical resistance, and durability.



Premium Multi-Step Finishing Process

1. The finest wood components are sanded with precision
2. A balanced base coat is applied to ensure a consistent, quality finish
3. First-stage ultraviolet (UV) curing process occurs
4. The wood is finely sanded and vacuumed
5. A tinted primer is applied as a foundation for our superior finish
6. Second stage UV curing
7. The wood is finely sanded and vacuumed
8. The solid paint layer is evenly applied
9. Third stage UV curing
10. The wood is finely sanded and vacuumed
11. First layer of water-based clear coat is applied
12. The components go through the dryer to prepare for final processing
13. The wood is finely sanded and vacuumed
14. Second layer of water-based clear coat is applied
15. The components go through the dryer once again
16. Final sanding for a smooth surface and vacuuming for a thorough cleaning
17. A final layer of topcoat is evenly applied
18. Oven curing for a catalyzed hardened finish
19. Visual inspection with a color consistency examination performed

The process for stained products varies slightly from the above steps.

What are **QuickBuild**® Cabinets?



Dovetail + Pocket Screws = QuickBuild®

Basic assembly of our cabinets is as simple as sliding the panels together and securing with pocket screws. You don't need extra fasteners to hold the panels in place, and conveniently placed pocket screws will reduce the average time you spend on each cabinet.



How fast can you build a cabinet?

One of our cabinets takes about 8 minutes* to assemble (many do it in 4).
You can build a kitchen or bathroom in record time!

*Specialty cabinets may take longer than average to assemble.

www.NorthPointCabinetry.com | 800.463.0660

Our Collections



PREMIER Collection

The Premier Collection features elegant upgrades like soft-close doors and drawers.

Door Styles: Catalina, Maui

- 3/4" solid wood face frame & shelves
- 1/2" plywood cabinet construction
- Premium 100% water-based finishes
- Beautiful, finished interior
- 5-Year limited lifetime warranty



Catalina Profile

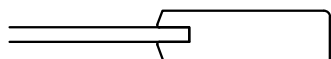

Maui Profile





The Essentials Collection delivers on style at an impressive value.

Door Style: Hatteras

- 3/4" solid wood face frame & shelves
- 1/2" plywood cabinet construction
- Premium 100% water-based finishes
- Beautiful, finished interior
- 1-Year limited lifetime warranty

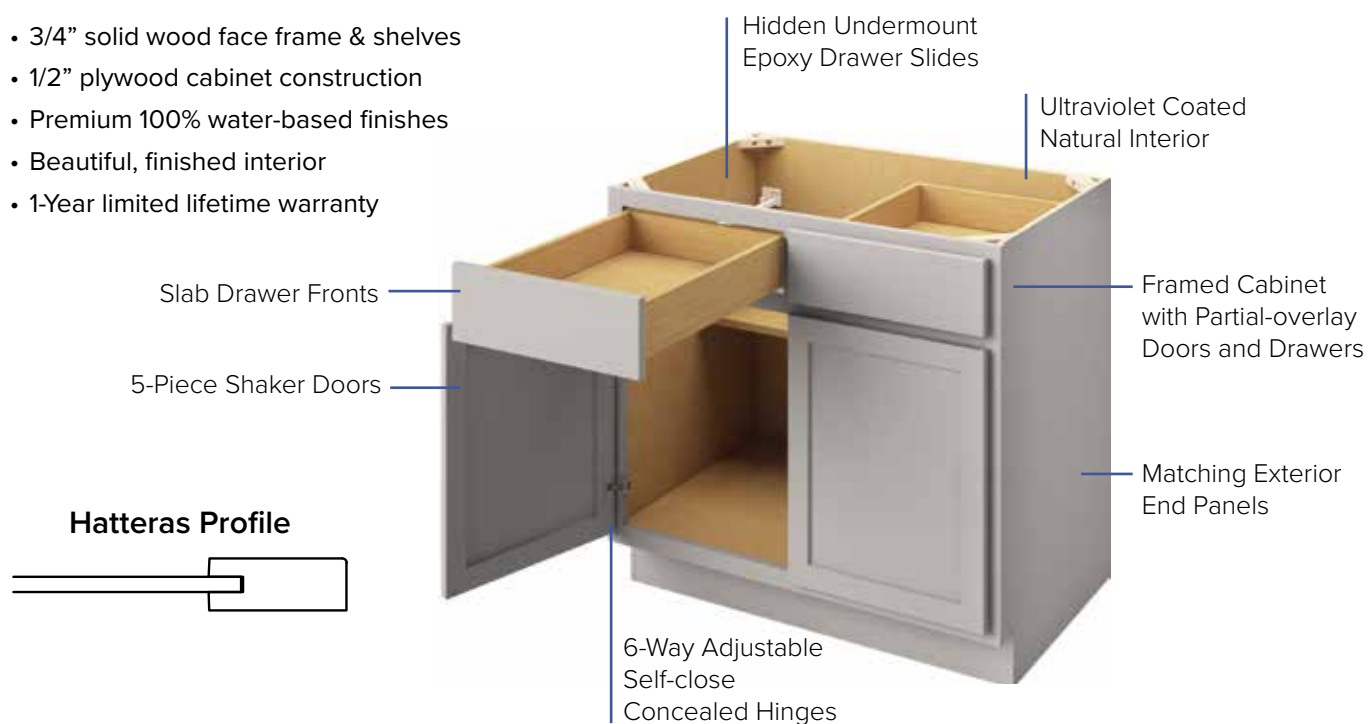

PREMIER COLLECTION: CATALINA



Cabinets and Island Shown in Catalina Slate
Decorative Cabinet Hardware: Dominique Collection in Satin Bronze



CATALINA FINISHES

More than modern. The Catalina door style features a full-overlay, Shaker style door and 5-piece drawer front.



POLAR WHITE



PEBBLE GREY



ESPRESSO



SLATE



PREMIER COLLECTION: MAUI



Cabinets Shown in Maui Polar White; Island Shown in Maui Espresso
Decorative Cabinet Hardware: Zane Collection in Polished Chrome



MAUI FINISHES

Sometimes the details make all the difference. The Maui door style features a full-overlay, transitional style door and 5-piece drawer front with a twist of character.



POLAR WHITE



PEBBLE GREY



ESPRESSO



SLATE



ESSENTIALS COLLECTION: HATTERAS



Cabinets & Island Shown in Hatteras Espresso
Decorative Cabinet Hardware: Sutton Collection in Polished Chrome



HATTERAS FINISHES

Simple and sleek. The Hatteras door style features a partial-overlay, Shaker style door and slab drawer front.



POLAR WHITE



PEBBLE GREY



ESPRESSO



Cabinets for Any Space

The kitchen and bath are common spaces to install cabinetry. However, NorthPoint Cabinetry provides solutions for other spaces like the laundry room, mudroom, and entertainment areas. Cabinets make those areas more functional by providing additional storage and countertop work space.



Wine Bar

Catalina Pebble Grey Cabinets

Decorative Cabinet Hardware: Marlo in Satin Nickel



Mudroom

Maui Polar White Cabinets
Decorative Cabinet Hardware:
Ella Collection in Brushed Oil
Rubbed Bronze
Decorative Hooks:
Emerald in Brushed Oil
Rubbed Bronze



Laundry Room

Catalina Slate Cabinets
Decorative Cabinet Hardware:
Hudson Collection
in Satin Nickel

Cabinet Lineup

WALL CABINETS

12" deep except where noted

42" high wall cabinets will have 3 shelves

*39" and 42" widths will have a vertical center stile unless otherwise noted

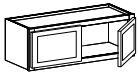

Double Door
12" Height
30", 33", 36",
or *39" Width

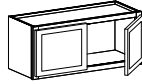

Double Door
15" Height
30", 33", 36",
or *39" Width

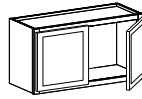

Double Door
18" Height
21", 24", 30", 33", 36",
or *39" Width

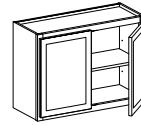

Double Door
24" Height
30", 33", 36", or *39" Width

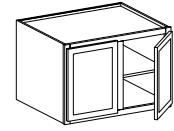

Deep Double Door
18" or 24" Height • 24" Depth
36" or *39" Width
18" Height does not have shelf

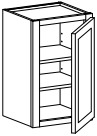

Single Door
30" Height
9", 12", 15", 18", or 21" Width

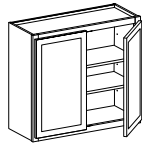

Double Door
30" Height
24", 27", 30", 33",
36", *39", or *42" Width

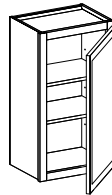

Single Door
36" Height
9", 12", 15", 18", or 21" Width

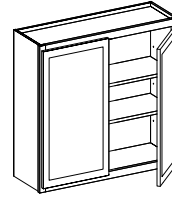

Double Door
36" Height
24", 27", 30", 33",
36", *39", or *42" Width

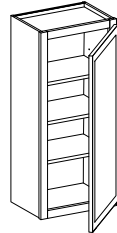

Single Door
42" Height
9", 12", 15", 18", or 21" Width

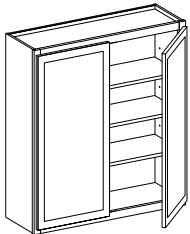

Double Door
42" Height
24", 27", 30", 33",
36", *39", or *42" Width

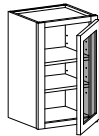

Single & Double Glass Door
Matching Finish Color Interior
30" Height
15", 18", 30", or 36" Width

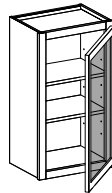

Single & Double Glass Door
Matching Finish Color Interior
36" Height
15", 18", 30", or 36" Width

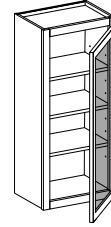

Single & Double Glass Door
Matching Finish Color Interior
42" Height
15", 18", 30", or 36" Width

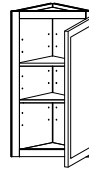

Wall End Single Door
30", 36", or 42" Height
12" Width

Glass door wall cabinets only available in the Premier Collection

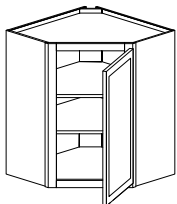

Diagonal Corner
30", 36", or 42" Height
12 or 15" Depth
24" or 27" Width

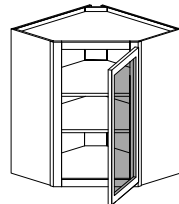

Diagonal Corner Glass Door
Matching Finish Color Interior
30", 36" or 42" Height
12 or 15" Depth
24" or 27" Width

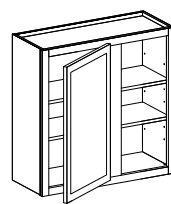

Universal Blind Corner
30", 36", or 42" Height
30"-33" Width

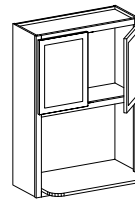

Microwave Wall Cabinet
Extended Shelf
36" Height
30" Width

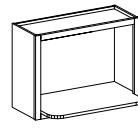

Microwave Wall Cabinet
Extended Shelf
18" Height
30" Width

Glass door wall cabinets only available in the Premier Collection

BASE CABINETS

24" deep, 34-1/2" high
except where noted

*39" and 42" widths will
have a vertical center stile
unless otherwise noted

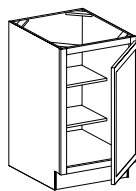

**Full Height
Single Door**
9", 12", 15", or 18" Width

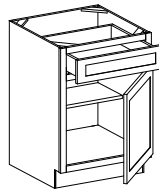

**Single Door
and Drawer**
12", 15", 18", or 21" Width

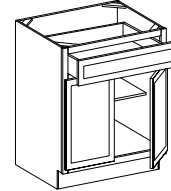

**Double Door and
Single Drawer**
24", 27", or 30" Width

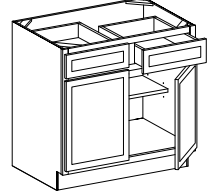

**Double Door and
Double Drawer**
33", 36", *39", or *42" Width

2,100 Cabinet Options in Stock for Quick Delivery

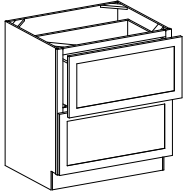

Double Drawer
30" or 36" Width

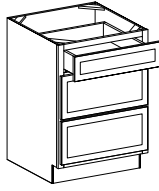

Triple Drawer
12", 15", 18", 21", 24", 30",
or 36" Width

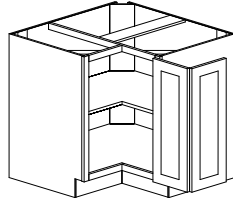

Base Corner Cabinet
33" or 36" Width
(Lazy Susan inserts available)

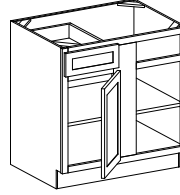

**Universal Blind
Base Corner**
39"–42", 42"–45", or
45–48" Width

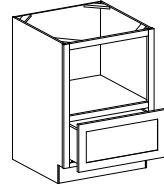

**Microwave Base
Cabinet with Drawer**
30" Width

SINK BASE CABINETS

24" deep, 34-1/2" high
except where noted.

*39" and 42" widths will
have a vertical center stile
unless otherwise noted

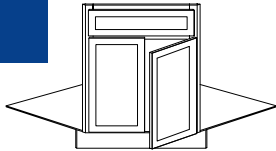

**Corner Sink Front
Double Door**
24" Depth
(2-piece bottom panel)

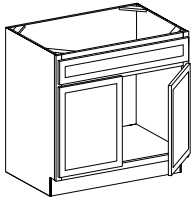

**Sink Base
Double Door**
30", 33", 36", or 39" Width

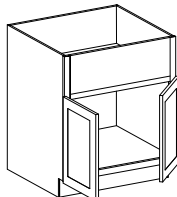

**Farmhouse Sink
Base Double Door**
36" or 39" Width
(No center stile)

TALL CABINETS

24" deep except
where noted.

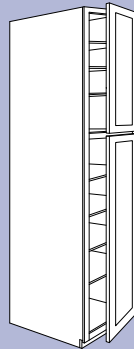

**Utility/Pantry
Single Door**
84", 90" (6 shelves),
or 96" Height (7 shelves)
18" Width

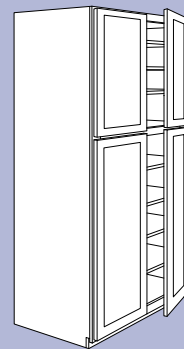

**Utility/Pantry
Double Door**
84", 90" (6 shelves),
or 96" Height (7 shelves)
24" or 30" Width

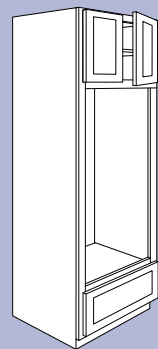

**Oven Double Door,
Single Drawer**
84", 90", or "96" Height
33" Width
*Single shelf in 96" only
(Double Oven Overlay Panel available)

VANITY CABINETS

21" deep, 34-1/2" high
except where noted

*42" widths will have a
vertical center stile

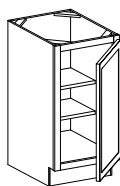

Single Door
12" Width

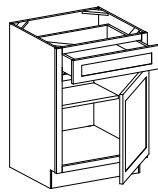

**Single Door
and Drawer**
12", 15", or 18" Width

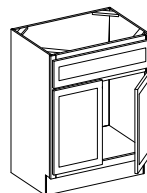

Double Door
24", 27", 30", 33",
or 36" Width

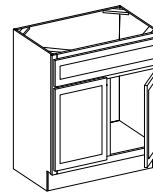

**Double Door
Center Stile**
42" Width

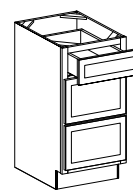

Triple Drawer
12", 15", 18", or
21" Width

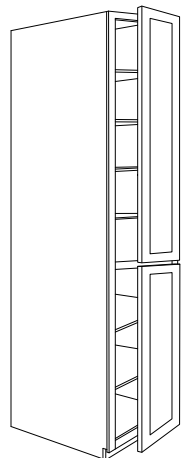

**Linen Single &
Double Door**
84" (6 shelves)
Single: 15" and 18" Width
Double: 24" Width

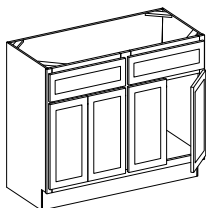

Two Double Door
48" Width

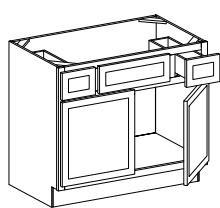

**Double Door and
Double Drawer**
36", 42", or 48" Width

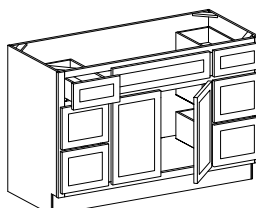

**Double Door and
Six Drawer**
60" Width

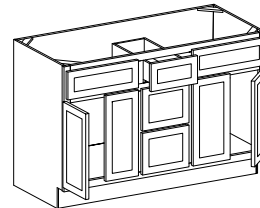

**Two Double Door and
Triple Drawer**
60" Width

Complete the Look - Accessories

Add the finishing touch to your customer's cabinets with our broad selection of cabinet accessories. Whether your client's ideal space is traditional, transitional, or contemporary, we have the selection available to transform the space from ordinary to extraordinary.



MOULDING

Crown, toe kick, light rail, scribe, and accent moulding options available

Available in all finishes:
Polar White, Pebble Grey,
Espresso & Slate

OVERLAY FILLERS

Fluted and smooth options available

Available in all finishes:
Polar White, Pebble Grey,
Espresso & Slate





DECORATIVE PANELS

Available in all finishes:
Polar White, Pebble Grey,
Espresso & Slate

DECORATIVE WOOD

Available in all finishes & door styles:
Polar White, Pebble Grey,
Espresso & Slate



SPECIALTY CABINETS

Available in all finishes:
Polar White, Pebble Grey,
Espresso & Slate

Resources

Assembly Videos



Base Cabinets
<https://delivr.com/2s43x>



Base Corner Cabinets
<https://delivr.com/2r23p>



Utility/Pantry Cabinets
<https://delivr.com/29fgn>



Double Oven Cabinets
<https://delivr.com/28pgy>

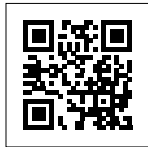

Wall Cabinets
<https://delivr.com/25hbr>

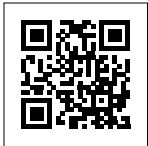

Wall Corner Cabinets
<https://delivr.com/2d3s3>

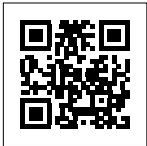

Wall End Cabinets
<https://delivr.com/2krhy>



Rollout Tray
<https://delivr.com/2fzzv>



Vanity Trim Kit
<https://delivr.com/23n8d>

NorthPoint Cabinetry Videos



NorthPoint Brand Overview
<https://delivr.com/2nyhg>



Anatomy of a Cabinet
<https://delivr.com/2zmba>

NorthPoint Cabinetry Website



www.NorthPointCabinetry.com

Literature & Samples

Available on the Resources section of our website.



Homeowner Catalog



Vanity Catalog



Homeowner
Selection Guide



Spec Book



Price Book



Mini Base Cabinets

The mini-base cabinet, a miniature version of our base cabinets, is available in the Premier Collection to demonstrate the quality and functionality of our cabinets without taking as much space as a full-sized cabinet.

Also available:
Touch Up Kits (not shown)
Cabinet Selection Center (coming soon)



Sample Door Kit

Ordering Made Easy

NorthPoint Cabinetry offers 3 convenient methods for easy order placement. We recommend placing orders online for faster processing and delivery and to easily confirm products are in stock.

1. Online: www.NorthPointCabinetry.com
2. Email: Orders@NorthPointCabinetry.com
3. Fax: (318) 742-9513

Order Placement

Place your online order by visiting www.NorthPointCabinetry.com. Login, select the items you wish to order, and simply checkout.

To order by email or fax, obtain a cabinet order form by logging in to the website, or request a form from a Customer Service team member or your sales representative. Submit the completed order form to the email address or fax number listed above. 2020 and ProKitchen material lists are also accepted as long as NorthPoint Cabinetry's item number nomenclature is used.

For questions about your order, call (800) 463-0660. Our friendly customer service agents are available to help you from 7am until 6pm Central Time.

Order Processing

Orders will be ready for pickup two hours after you have received your order confirmation email. Will Call orders are available for pickup at our facilities between the hours of 8am and 4pm local warehouse time. Should you have any questions about picking up your order or need to have the order modified in any way, contact your customer service representative. All requests for returns must be made within 60 days of invoice date. Returns are subject to a 20% restocking fee unless the return is due to Hardware Resources' error or a quality issue.

Returns

To request a Return Goods Authorization (RGA) contact Customer Service.

1. Phone: (800) 463-0660
2. Fax: (318) 742-9513
3. Email: ReturnRequest@HardwareResources.com

Include the item number, quantity and reason for return when requesting an RGA. Items should be in original packaging, unassembled, and shipped with care to avoid damage. Items received with damage may not be credited.

In the event that the return is due to an error by Hardware Resources, a return shipping label will be provided. Otherwise, shipments are the Customer's responsibility (including shipping fees) and should be shipped via a method which allows shipment tracking and proof of delivery.

Warranty

Premier Collection

Hardware Resources warrants to the original consumer purchaser that our Premier Cabinetry will be free from unnatural defects in material and workmanship under normal use and proper care for the period of FIVE (5) YEARS from the date of original purchase. This Limited Warranty applies only to the Original Purchaser and is not transferable to any other party.

WARRANTY COVERAGE

Limited 5-Year Warranty on Cabinets to the original purchasing consumer from the date of original purchase that the cabinets will be free from defects in material and workmanship under normal use and proper care. Limited Lifetime Warranty on Drawer Slides and Hinges to the original purchasing consumer as long as they own the product. We warrant that the drawer slides and hinges shall be free from defects in material and workmanship under normal use.

Essentials Collection

Hardware Resources warrants to the original consumer purchaser that our Essentials Cabinetry will be free from unnatural defects in material and workmanship under normal use and proper care for the period of ONE (1) YEAR from the date of original purchase. This Limited Warranty applies only to the Original Purchaser and is not transferable to any other party.

WARRANTY COVERAGE

Limited 1-Year Warranty on Cabinets and on Drawer Slides to the original purchasing consumer from the date of original purchase that the cabinets will be free from defects in material and workmanship under normal use and proper care. Limited Lifetime Warranty on Hinges to the original purchasing consumer as long as they own the product. We warrant that the drawer slides and hinges shall be free from defects in material and workmanship under normal use.

DESIGN TOOLS

NorthPoint Cabinetry products are available in ProKitchen and 2020 Design Software so that you have access to the right tools to create amazing spaces.



www.ProKitchenSoftware.com



www.2020spaces.com



Let us quote a full kitchen
and **see the value!**

**NORTH
POINT**
CABINETS®

hardware
resources®



To learn more about the quality accessories we offer or other products we manufacture visit www.NorthPointCabinetry.com, call 1-800-463-0660 or scan the QR code with your smartphone or mobile device.